

ELECTRIC BAG-IN-BOX PUMP



The Flojet Model 2125 Series Pump

- Ideal for Bag-in-Box rack systems.
- Pumps post-mix soda and juice syrups, coffee, tea, and other non-carbonated products.
- Electric pump for applications where CO₂ is not available.

TYPICAL INSTALLATION

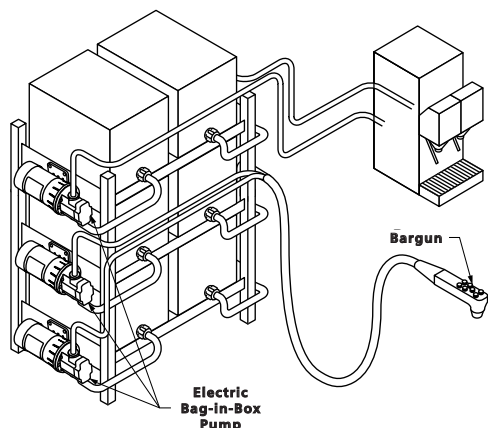

SPECIAL FEATURES

- Built-in vacuum switch shuts off pump when bag is empty. When full bag is connected, pump will restart after resetting.
- Pressure switch automatically starts the pump when the valve/bargun is opened and stops the pump when the valve/bargun is closed.
- Compact unit is self-priming and can run dry for long periods.
- Simple and quick to install.
- Integral check valve maintains uniform pressure at the dispensing valve when pump is not operating.
- UL listed motor.
- NSF listed, Standard 18.

DISPENSING APPLICATIONS

- Post-mix syrups and juice products (non-pulp) with brix ratios of 5-1 to 1-1.
- Wine and liquor applications up to 3 oz/sec. (85.24 ml/sec.) with remote dispensing valves.
- Ideal for mobile carts or vending applications, eliminates the need for CO₂ to operate pumps.

INSTALLATION RECOMMENDATIONS

- Use plastic port fittings.
- Pump should be mounted horizontally beneath Bag-in-Box to ensure total evacuation.
- Can pump up to 50 ft. (15.2 m) horizontal with 10 ft. (3 m) vertical rise.

SPECIFICATIONS

Pressure Switch	45 PSI (3.1 bar) max. 50 PSI (3.4 bar) max. 90 PSI (6.2 bar) max.
Ports	1/4" NPT
Liquid Temperature	110°F/43.4°C Nominal
Wetted Parts:	
Housing	Polypropylene
Elastomers	Santoprene*
Net Weight	4 lbs (1.87 kg)
Pump Design	Duplex Diaphragm
Motor	Permanent Magnet with solid state rectifier
Voltage	115 Volt AC
Cycles	50/60 Hz
Recommended Duty Cycle	25%

*Registered Trademark of Monsanto Co.

DIMENSIONS inches (mm)

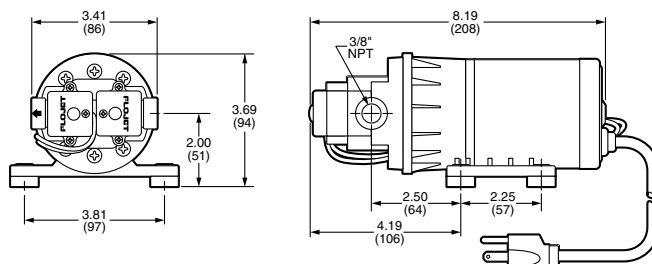

VOLTAGE TABLE

Voltages	45 PSI (3.1 bar) Pressure Switch	50 PSI (3.4 bar) Pressure Switch	90 PSI (6.2 bar) Pressure Switch
115 Volt AC	2125-504	2125-030	2125-507



For further information, contact your FLOJET representative, or write to:

U.S.A.
Flojet
666 E. Dyer Road
Santa Ana, CA 92705
Tel: 714.557-4700
Fax: 714.628.8478

FLOJET (EUROPE) LTD.
Unit 1, Avant Business Centre
Denbigh West Industrial Estate
Milton Keynes, MK1 1DL
Tel: 44-1908-370088
Fax: 44-1908-373731